

Theme builder

Last Modified on 05/12/2026 3:10 pm IDT

 This article is designated for administrators.

About

With our enhanced Theme builder, you have the power to craft a unique and personalized theme for your site effortlessly.

By simply selecting a single primary color, you can seamlessly transform your entire site with perfectly coordinated complementary shades.

The process of refining your site's appearance to align with your vision is now remarkably simple, granting you the ability to achieve your desired aesthetic effortlessly.



Changes made in the Theme builder will apply to all pages across your site that are part of the **Theming** design system!

Check out our improved Theme builder below:

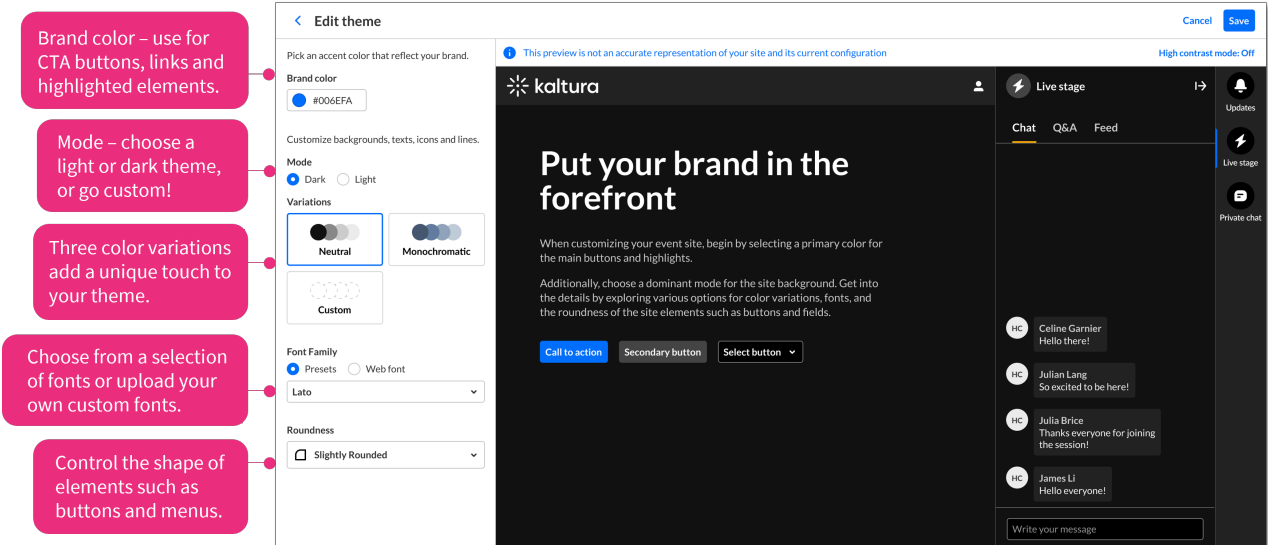

The screenshot shows the 'Edit theme' interface. On the left, there are five callout boxes with pink backgrounds and white text, each pointing to a specific control in the theme editor:

- Brand color – use for CTA buttons, links and highlighted elements.** Points to the 'Brand color' field with the value '#006EFA'.
- Mode – choose a light or dark theme, or go custom!** Points to the 'Mode' section with 'Dark' selected.
- Three color variations add a unique touch to your theme.** Points to the 'Variations' section with 'Neutral' and 'Monochromatic' options.
- Choose from a selection of fonts or upload your own custom fonts.** Points to the 'Font Family' section with 'Presets' selected and 'Lato' chosen.
- Control the shape of elements such as buttons and menus.** Points to the 'Roundness' section with 'Slightly Rounded' selected.

The main interface shows a preview of a site with the following text: 'Put your brand in the forefront', 'When customizing your event site, begin by selecting a primary color for the main buttons and highlights.', and 'Additionally, choose a dominant mode for the site background. Get into the details by exploring various options for color variations, fonts, and the roundness of the site elements such as buttons and fields.' Below this is a preview of three buttons: 'Call to action', 'Secondary button', and 'Select button'. The right sidebar shows a 'Live stage' chat interface with messages from Celine Garnier, Julian Lang, Julia Brice, and James LJ.

Access the Theme builder

1. Go to your Configuration Management console, and click the **Theming** module. You can also navigate directly: https://{your_site_URL}/admin/config/tab/theming.

- Staticpages
- Styling
- Templatepages
- Theming** ←
- Thumbnails
- Twitter
- Uploadmedia
- Userreports

2. In the Themes section, click **Add Themes**.

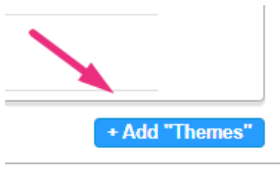

3. Click **Edit**.



The Theme builder opens.

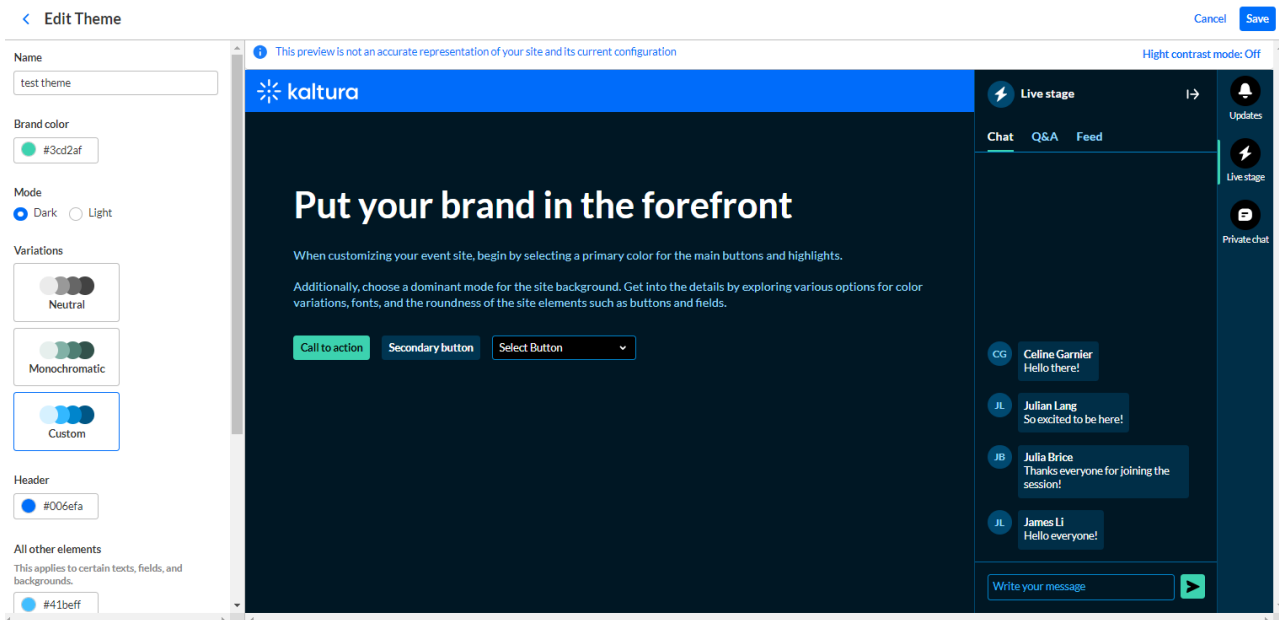

Create a theme



Please note that if you're editing an older version of the theme using this editor, any changes you make will replace previous modifications and cannot be reversed.

Brand color

The brand color is used as an accent color, reflected in interactive elements such as call-to-action buttons, links, and highlighted elements.

Brand color



You can change the color by clicking on it and opening the color palette, or by typing in a Hex code.



When you change the color, you can see how it looks in real-time in the preview window.



The preview is simply a guide and not an accurate representation of your whole site and its current configuration.

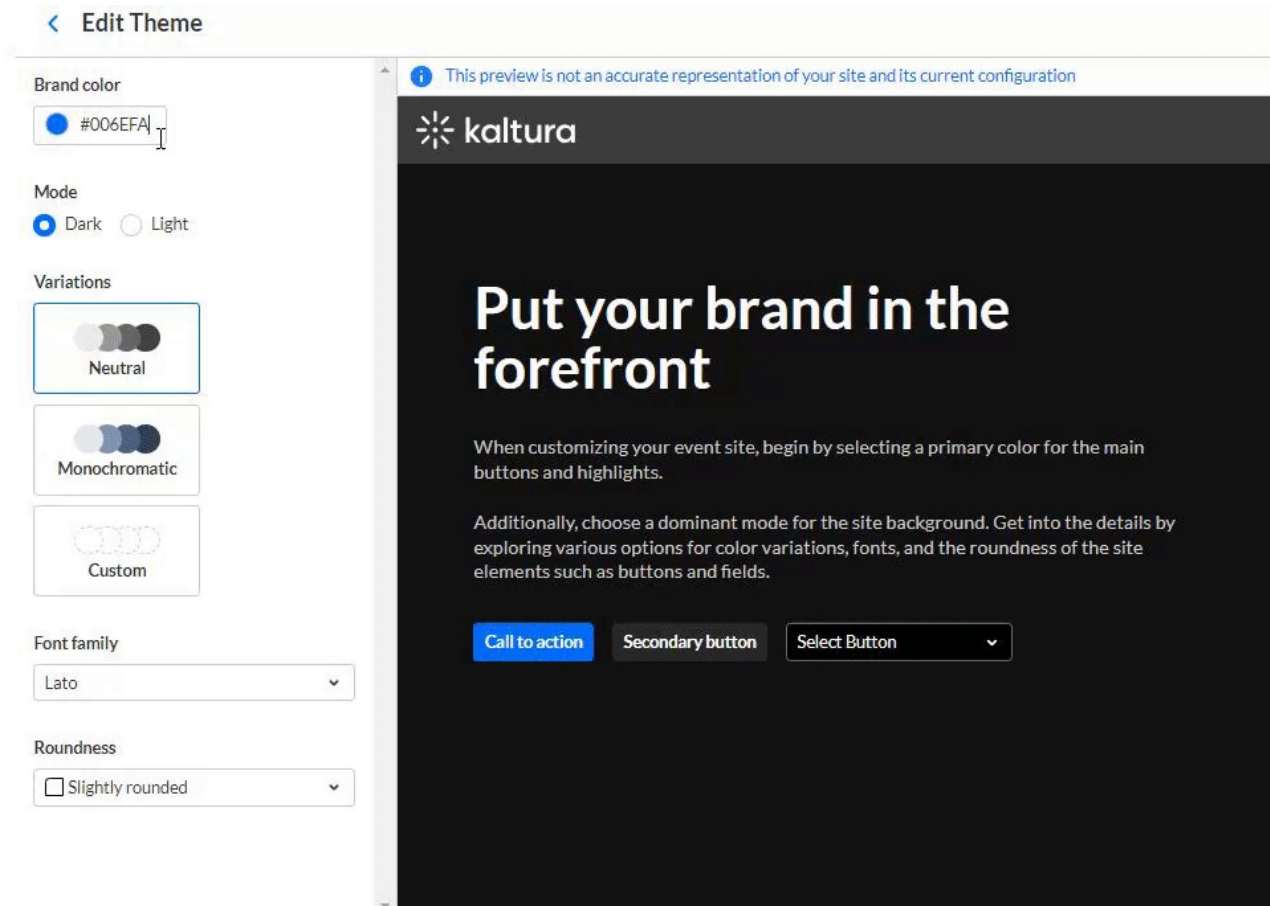

Mode

Select the theme color mode from one of the following options:

- Dark Mode
- Light Mode

The mode also allows you to create your own custom theme.

Variations

The color scheme offers several options to add a unique touch to your theme. It controls the colors of your backgrounds, text, and other UI elements. You can select from three options:

- **Neutral** - The scheme will be composed with shades of neutral tones.
- **Monochromatic** - The scheme will use hues from your brand color to create a low-saturated color palette.
- **Custom** - This gives you more options, for example, you can set a color for your header and choose a specific color to create the color palette for the rest of the UI elements.

Mode
 Dark Light

Variations

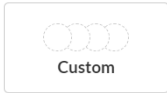

Custom

Note that there are two different colors you can use. You can choose a color for the header and a secondary color that will affect the hue of your site.

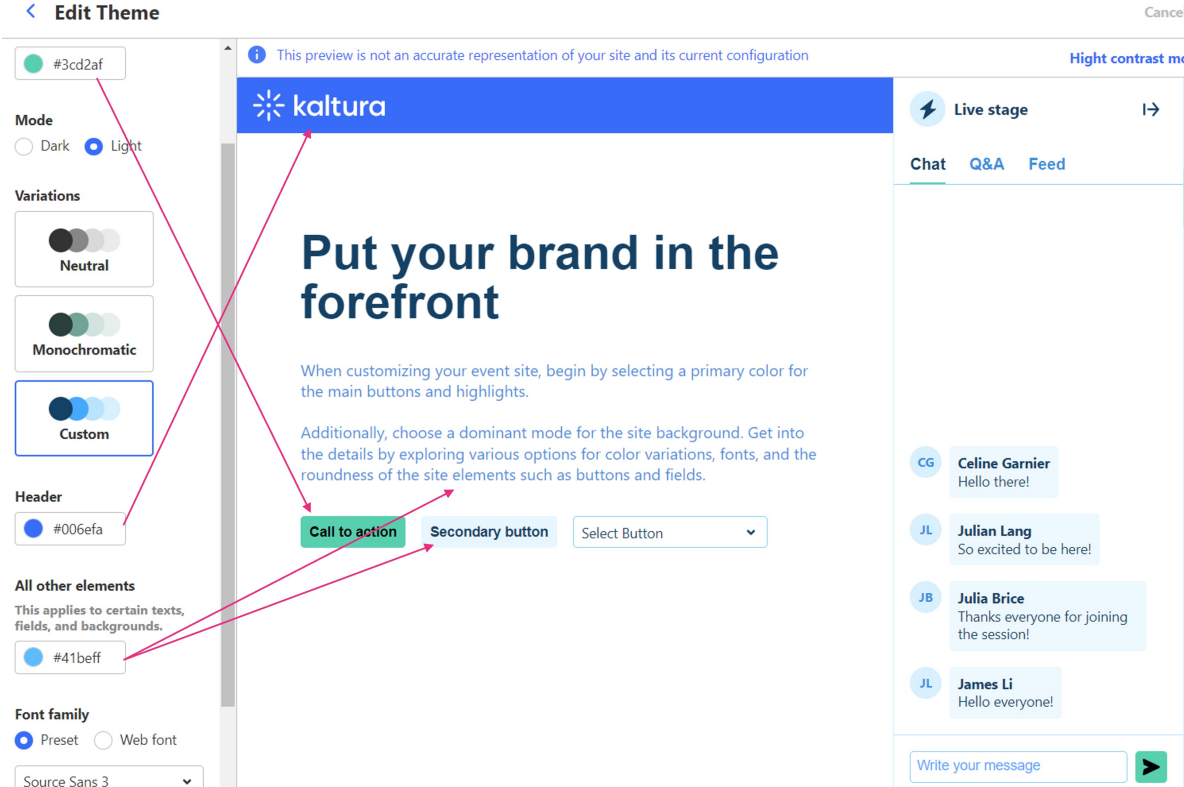

The screenshot shows the 'Edit Theme' interface. On the left is a configuration sidebar with the following sections:

- Color Picker:** A color swatch with the hex code #3cd2af.
- Mode:** Radio buttons for 'Dark' (selected) and 'Light'.
- Variations:** Three color palette options: 'Neutral', 'Monochromatic', and 'Custom' (selected).
- Header:** A color swatch with the hex code #006efa.
- All other elements:** A note 'This applies to certain texts, fields, and backgrounds.' followed by a color swatch with the hex code #41beff.
- Font family:** Radio buttons for 'Preset' (selected) and 'Web font', with a dropdown menu showing 'Source Sans 3'.

The main preview area shows a site header with the Kaltura logo and the text 'Put your brand in the forefront'. Below the header are three buttons: a green 'Call to action' button, a blue 'Secondary button', and a white 'Select Button' dropdown menu. Red arrows point from the 'Call to action' and 'Secondary button' in the sidebar to their respective buttons in the preview. Another red arrow points from the 'Header' color swatch to the blue header bar in the preview. A third red arrow points from the 'All other elements' color swatch to the 'Call to action' button. The right side of the preview shows a chat interface with a 'Live stage' indicator and a list of chat messages.

The 'Select Button' demonstrates the chosen Theming for drop-down menus.

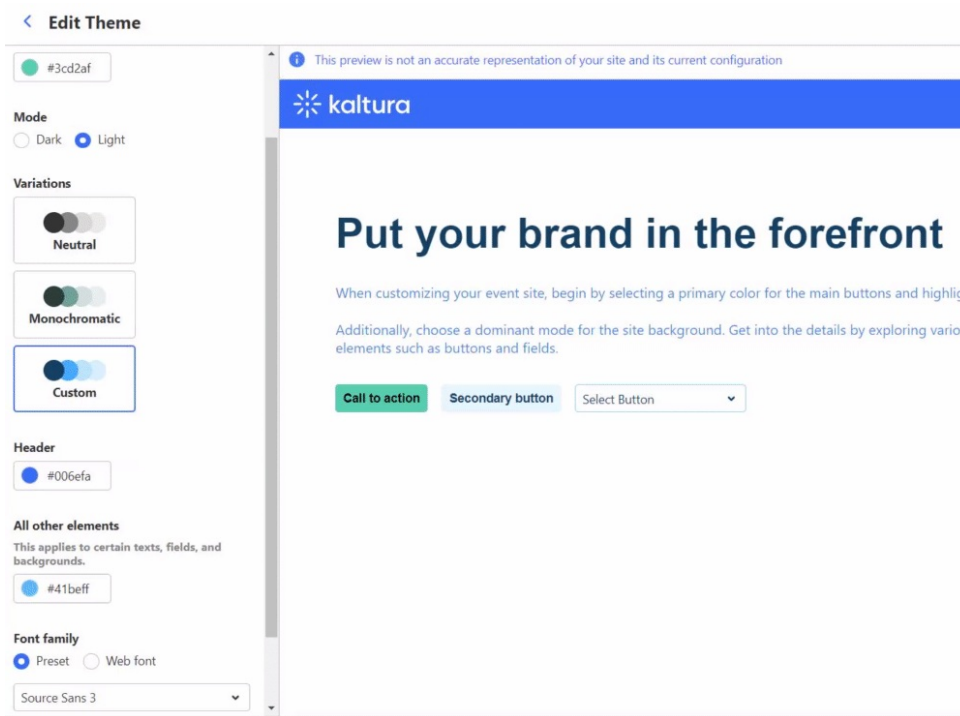

Font family

Choose **Presets** or **Web font**:

Presets - Select a font family from one of the following 26 options:

<ul style="list-style-type: none"> • Arial • Garamond • Georgia • Lato (Default) • Sans-serif • Tahoma • Times New Roman • Trebuchet MS • Verdana 	<ul style="list-style-type: none"> • Cardo • DM Sans • Fira • Inter • Libre Baskerville • Libre Franklin • Merriweather • Nunito Sans • Open Sans 	<ul style="list-style-type: none"> • Roboto • Roboto Condensed • Roboto Slab • Rubik • Source Sans 3 • Space Grotesk • Work Sans • Zilla Slab
--	--	---

Font family

Preset Web font

Lato

Roundness

Slightly rounded

Web font - When you click Web font, additional functions display:

Font family

Preset Web font

External stylesheet URL  

https://...

Font family name 

Example: 'Tangerine'

External stylesheet URL - Enter a stylesheet URL that contains your embedded fonts, for example:

<https://fonts.googleapis.com/css2?family=Roboto:wght@400;700&display=swap>



Only a single font family should be embedded. We recommend to include the following weights: 400 (normal) and 700 (bold).

Font family name - Enter the font family name (for example, 'Tangerine') as specified in the stylesheet, or as supplied by your provider.

Roundness

Select the roundness of UI elements such as buttons, input fields, and certain menus. Choose from the following options:

- Sharp Edges
- Slightly Rounded (Default)
- Rounded

Roundness

Slightly Rounded

Sharp edges

Slightly rounded

Rounded

When you're happy with your configuration, click **Save**.

Exit the Theme Editor by clicking the back arrow.

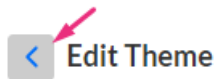

When your new theme is ready, learn how to apply it to your site in the [Theming module](#).
