

Access a channel playlist

 This article is designated for all users.

1. Select **My Channels** from the user menu  .

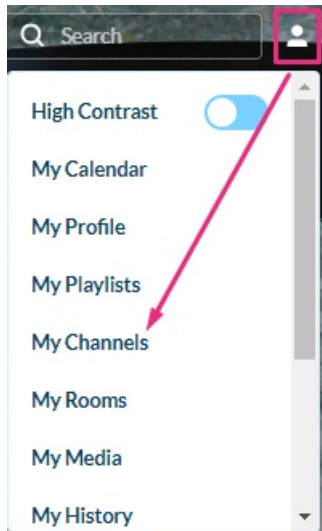

The **My Channels** page displays.

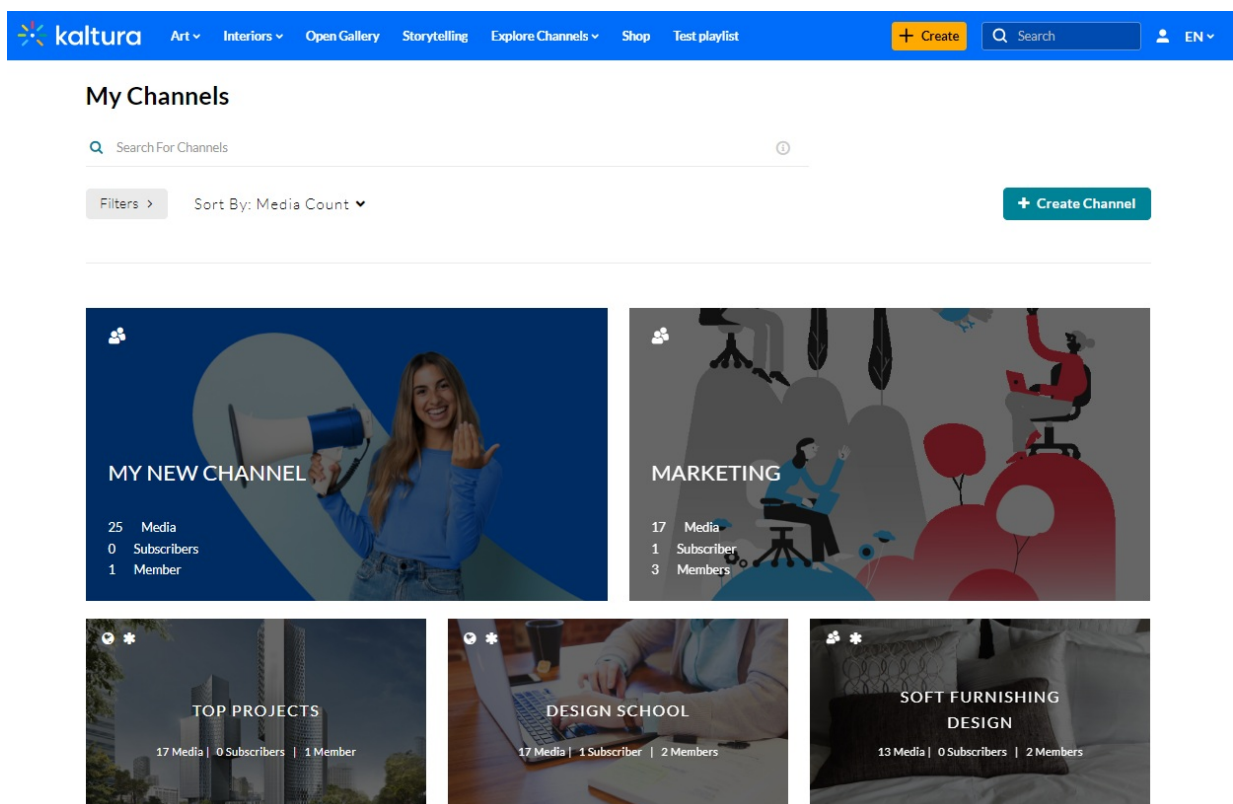

2. Click on a channel's thumbnail to open the page.

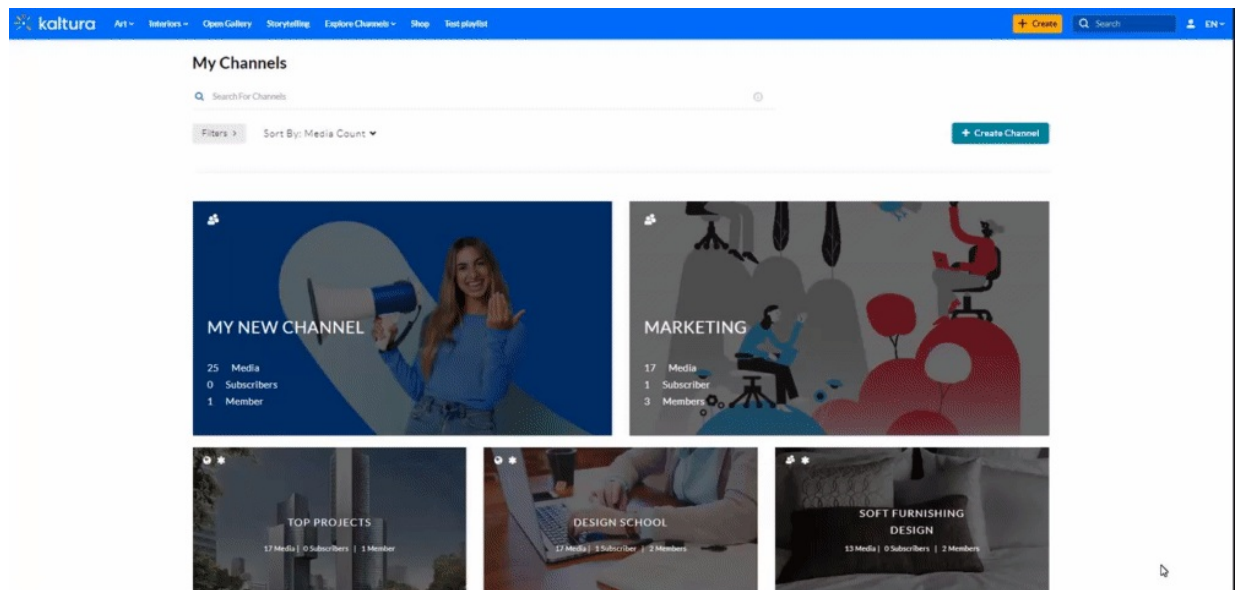

3. The channel playlists tab displays.

 The Playlists tab only appears if playlists are available in the channel

4. Click **See All** to see the entire playlist.

New playlist about interior design

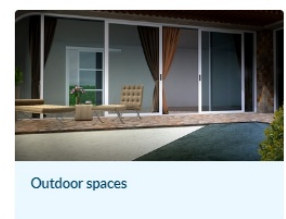
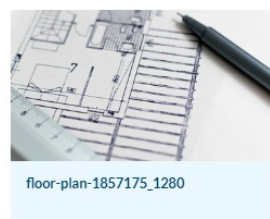
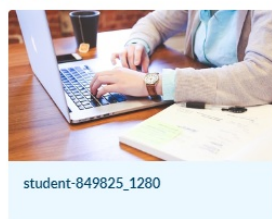

 [See All](#)

Playlists are displayed with a name, description and accompanying media thumbnails to identify the content. The example below has the **playlists grid** layout enabled in the Theming module. If your playlist doesn't look like this, see [Theming](#) for more information.

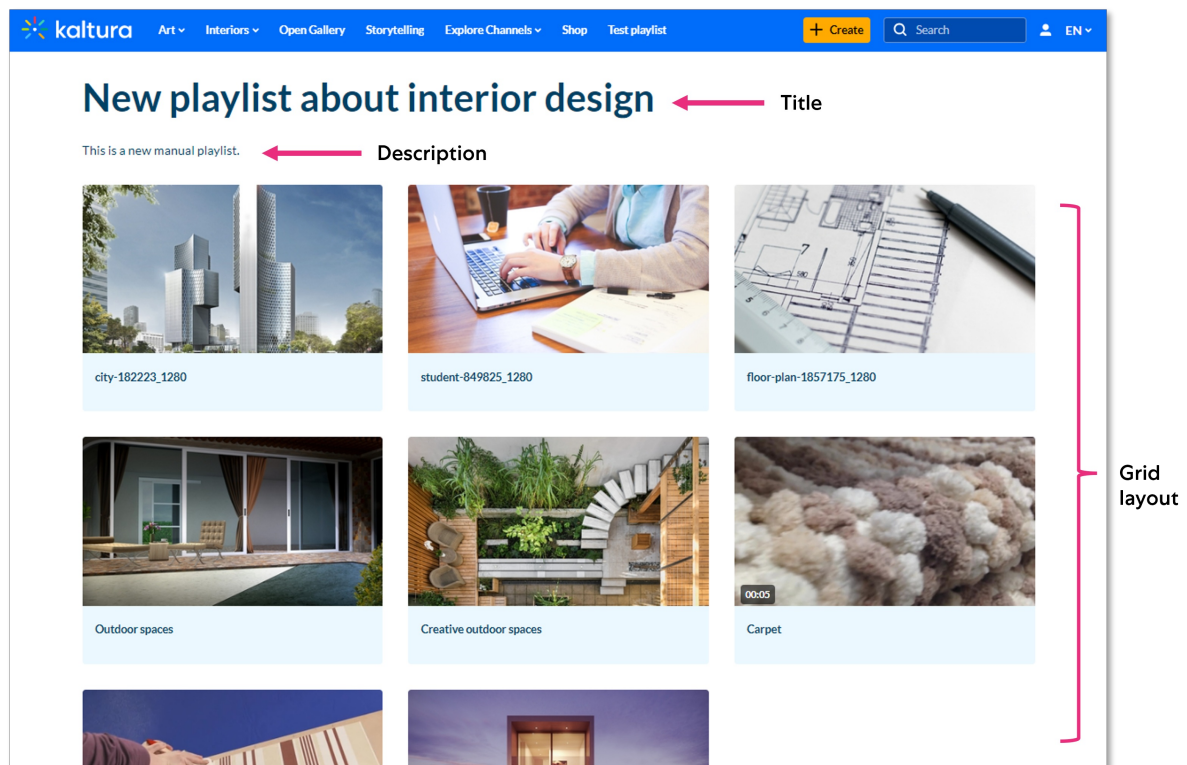

- Click on the thumbnail or the playlist name to watch. Depending on your Playlistpage module configuration, you'll either be directed to the playlist page or to the single media page without the context of the playlist. For more details, refer to our article [Playlistpage](#).

The example below shows the playlist page with the player pointing to the selected media.

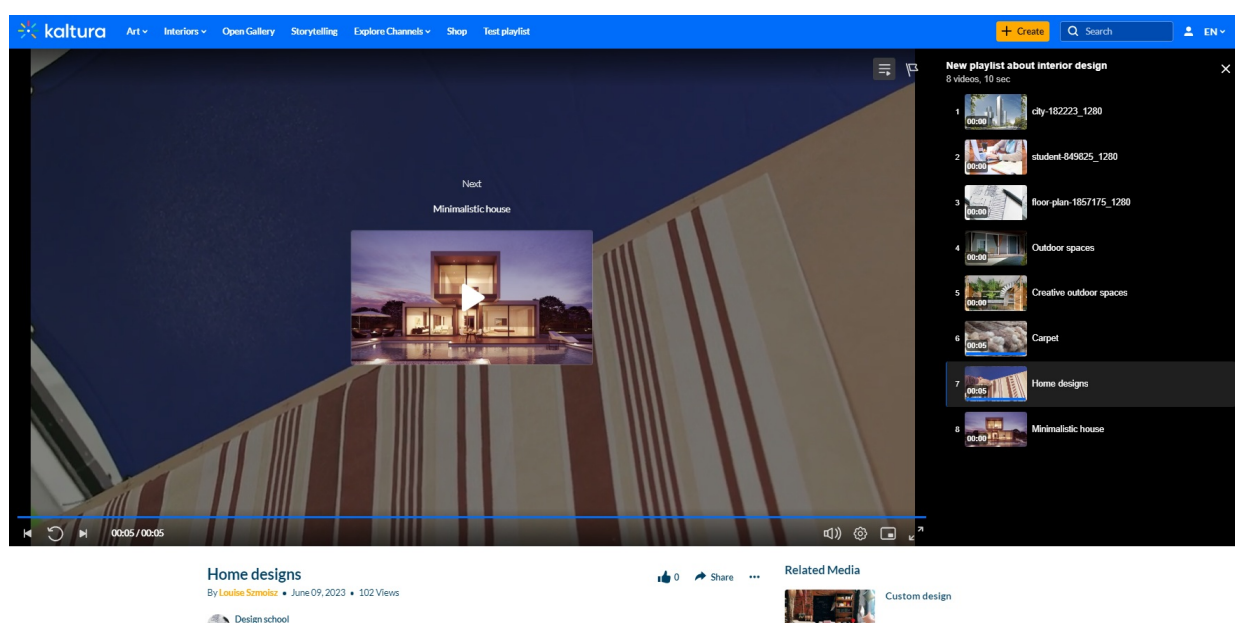

[template("cat-subscribe")]

